

ESTIMATION AND COSTING

SHREE AGRO INDUSTRIES (PROP.MR.SAGAR UTTAM GHORPADE)

SHREE AGRO KRUSHI FARMERS PRODUCER COMPANY LTD.

A/P DAHIWADI,TAL-MAN

DIST -SATARA 415508

Unit 1 =2006.03 SQ.M

Sr. No.	Description	Qty	Unit	Rate	Amount
1	Excavation for foundation in earth, soil of all types, sand, gravel and soft murum, including removing the excavated material up to a distance of 50 m. beyond the building area & stacking and spreading as directed, dewatering, preparing the bed for the foundation and necessary back filling, ramming, watering including shoring and strutting etc. complete. (Lift upto 1.5 m.)	280.670	M3	175.00	49117.25
2	Excavation for foundation in hard murum including removing the excavated materials upto distance of 50 metres beyond the building area and stacking and spreading as directed, dewatering, preparing the bed for the foundation and necessary back filling, ramming, watering including shoring and strutting etc. complete. (Lift upto 1.50 m)	150.890	M3	185.00	27914.65
3	Excavation for foundation in Hard rock by blasting including trimming and leveling the bed by chiseling where necessary and removing the excavated materials and stacking it in measurable heaps within a distance of 50 metres from the building area including dewatering and back filling with available earth murum watering ramming, complete.	55.460	M3	760.00	42149.60

4	Providing uncoursed rubble masonry of trap/granite /quartzite /gneiss stones in cement mortar 1:6 in foundations and plinth of inner walls/in plinth of external walls including bailing out water, striking complete.	90.23	M3	2650.00	239109.50
5	Filling in plinth and floors with approved excavated materials in 15 cm to 20 cm layers including watering and compaction complete.	1963	M3	65.00	127595.00
6	Filling in plinth and floors with contractors soil sand or murum in 15 cm to 20cm, layers including watering and compaction complete.	1523.30	M3	283.00	431093.90
7	Providing dry/ trap/ granite/ quartzite/ gneiss rubble stone soiling 15 cm to 20 cm thick including hand packing and compacting complete.	369.320	M3	835.00	308382.20
8	Providing and laying in situ, cement concrete 1:4:8 in M-10 of trap/ granite/ quartzite/ gneiss metal for foundation and bedding including bailing out water, formwork, compacting and curing complete	333.600	M3	3550.00	1184280.00
9	Providing and laying in situ cement concrete M-20 of trap / granite /quartzite/ gneiss metal for R.C.C. work in foundations like raft, strip foundations, grillage and footings of R.C.C. columns and steel stanchions etc. including bailing out water, formwork, cover blocks compaction and curing roughening the surface if special finish is to be provided. (Excluding reinforcement & structural steel) complete.	78.900	M3	4895.00	386215.50
10	Providing and laying in situ cement concrete M-20 of trap / granite /quartzite/ gneiss metal for R.C.C. work in columns as per detailed designs & drawing including formwork, cover blocks compaction and curing roughening the surface if special finish is to be provided (Excluding reinforcement and structural steel) complete . With natural sand.	23.300	M3	9325.00	217272.50

11	Providing and casting in situ cement concrete in M-25 of trap/ granite/ quartzite/ gneiss metal for R.C.C. beams and lintels as per detailed designs and drawings or as directed including centering, formwork, cover blocks compaction and roughening the surface if special finish is to be provided and curing complete.	39.900	M3	8305.00	331369.50
12	Providing and casting in situ cement concrete in M-25 of trap/ granite/ quartzite/ gneiss metal for R.C.C. Chajja as per detailed designs and drawings or as directed including centering, formwork, cover blocks compaction and roughening the surface if special finish is to be provided and curing complete.	12.900	M3	8605.00	111004.50
13	Providing and laying in situ cement concrete M25 of 200 mm Thick trap/ granite/ quartzite gneiss metal for RCC work for Floor etc. including bailing out water, formwork compaction curing etc complete. (Excluding reinforcement, & structural steel)	148.900	M3	6950.00	1034855.00
14	Providing and applying Tremix treatment to the cement concrete floor comprising of screed vibrating and levelling of concrete surface, vacuum dewatering, bull floating and striking off, power floating and power trowelling, curing by ponding for 14 days, cleaning, including Groove cutting etc. complete.(The tremix concrete surface to be thoroughly cleaned with washing, manual scraping of all the adhered dust, after the curing is over And the concrete surface should be completely dry)	998.000	M2	165.00	164670.00
15	Providing and fixing in position HYSD steel bar reinforcement of various diameters for RCC Pile, Caps, Footings, Foundations, Slabs, Beams, coloums, chajjas, lintels, Pardi etc as per details designs, drawings and schedules the bars binding with wires or tack welding and supporting as required complete.	39.100	M.T.	50660.00	1980806.00

16	Providing second class Burnt Brick masonry with conventional/ I.S. type bricks in cement mortar 1:6 in superstructure including striking joints, racking out joints, watering and scaffolding complete.	368.900	M3	4930.00	1818677.00
17	Providing and fixing teakwood for doors and window frame of 100mm x 60mm x 1.2mm thick including necessary holdfast, hinges, tie rods including anti corrosive treatment like phosphating & zinc chromate primer coat. All complete as per drawing & specifications.	207.800	M2	428.00	88938.40
18	Providing and fixing steel window of various sizes as per detailed drawing without hot dip zinc coating, without ventilators, including fabricating / glazing with plain / obscured glass panels of approved type and quality, iron oxidised fixtures and fastenings, oil painting two coats complete.	34.900	M2	2893.00	100965.70
19	Providing and fixing rolling shutter fabricated from steel laths of minimum thickness 0.9 mm with lock plate of 3.15 mm thickness reinforced with 35 x 35 x 5 mm angle section fitted with sliding bolts and handles for both sides, deep M.S. channel section of depth and thickness not less than 65 mm and 3.15 mm respectively with hold fast arrangements, M.S. Bracket plate 300 x 300 x 3.15 mm minimum size and shape with square bar, suspension shaft of minimum 32 mm diameter, hood cover of M.S. sheet not less than 0.9 mm thickness and of any size at top and safety devices including mechanical gear operation arrangement consisting of worm gear wheels and worms of high grade cast iron or mild steel and one coat of red	79.050	M2	3685.00	291299.25
20	Providing internal cement plaster 6 mm thick in a single coat in cement mortar 1:4 without neeru finish to concrete & Brick surface in all positions including scaffolding and curing complete.	673.900	M2	282.00	190039.80

21	Providing sand faced plaster externally in cement mortar using approved screened sand, in all positions including base coat of 15 mm thick in cement mortar 1:4 using waterproofing compound at 1 kg per cement bag curing the same for not less than 2 days and keeping the surface of the base coat rough to receive the sand faced treatment 6 to 8 mm thick in cement mortar 1:4 finishing the surface by taking out grains and curing for fourteen days scaffolding etc.complete.	409.000	M2	398.00	162782.00
22	Providing structural steel work in trusses, other similar trussed purlins and members with all bracing, gusset plates etc. as per detailed designs and drawings or as directed including cutting, fabricating, hoisting, erecting fixing in position, Making riveted/ bolted/ welded connection and one coat of anticorrosive paint and over it 2 coats of oil painting complete.	50.320	M.T.	67000.00	3371440.00
23	Providing and fixing corrugated galvanised iron sheets of 0.80mm thick (22 B.W.G.) for roofing without wind tiles including fastening with galvanised / iron screw / bolt and lead / bitumen washers as per drawing complete.	750.000	M2	806.00	604500
24	Providing and applying Electrical work any labor or material used in installing, altering, maintaining, or extending an electrical wiring system and the appurtenances, apparatus, or equipment used in connection with the use of electrical energy in, on, outside, or attached to a building, residence, structure, property, or premises. The term includes service entrance conductors as defined by the National	759.5	M2	1315.60	999198.2
25	Providing and applying washable oil bound distemper for internal plastered surface of approved colour and shade to old and newsurface in two coats including scaffoldings, preparing the surface.(Excluding the primer coat) complete.	6500	M2	35.00	227500
Total Amount Rs					14491175.45
26	DRAINAGE, PLUMBING, FITTING	L.S3%			434736.00

27	LIGHT FITTING AND ELECTRICITY	L.S3%	434736.00
28	WATER CHARGES	L.S3%	434736.00
29	BUILDING DRAWING, PLANING, SUPERVISION	L.S5%	724559.00
			16519940.00
TOTAL ESTIMATED COST UNIT 2			16520000.00

IN WORDS RUPEES One CRORE SIXTY FIVE LAKH TWENTY THOUSAND ONLY.

**NAME OF OWNER=SHREE AGRO KRUSHI
FARMERS PRODUCER COMPANY LTD.**

SIGN OF ENGINEER

|

|

OWNERS DECLARATION:-

I/WE UNDERSIGNED HEREBY CONFIRM THAT I/WE WOULD BE RESPONSIBLE FOR THE PROPER CONSTRUCTION OF THE STRUCTURE AS PER APPROVED PLANS ALSO I/WE WOULD EXECUTE THE WORK UNDER SUPERVISION OF PROPER TECHNICAL PERSON SO AS TO ENSURE THE QUALITY AND SAFETY AT THE WORK SITE.

OWNER:-

**SHREE AGRO INDUSTRIES
(PROP. MR. SAGAR UTTAM GHORPADE)**

TITLE:-

PROPOSED COMMERCIAL BUILDING AT DAHIWADI TAL. MAN. DIST. SATARA AT GAT NO. 2168/1 FOR SHREE AGRO INDUSTRIES. (PROP. MR. SAGAR UTTAM GHORPADE)

CERTIFICATE OF AREA

CERTIFIED THAT THE PLOT UNDER REFERENCE WAS SURVEYED BY ME ON AND THE DIMENSIONS OF SIDES ETC. OF PLOT STATED ON PLAN ARE AS MEASURED ON SITE AND THE AREA SO WORKED OUT TALLIES WITH THE AREA STATED IN DECREE OF COMPETENT AUTHORITY IN RECORDS AND RECORDS OF APPOINTMENT SURVEY RECORD.



ARCHITECTS / LICENSED ENGINEERS
STRUCTURAL ENGINEER / SUPERVISOR
MR. VISHAL S. GHORPADE
CIVIL ENGINEER AND GOVT. CONTRACTOR
Office Add:- P.O. Dahiwadi Tal. Man. Dist. Satara.

NORTH



SCALE

1:100

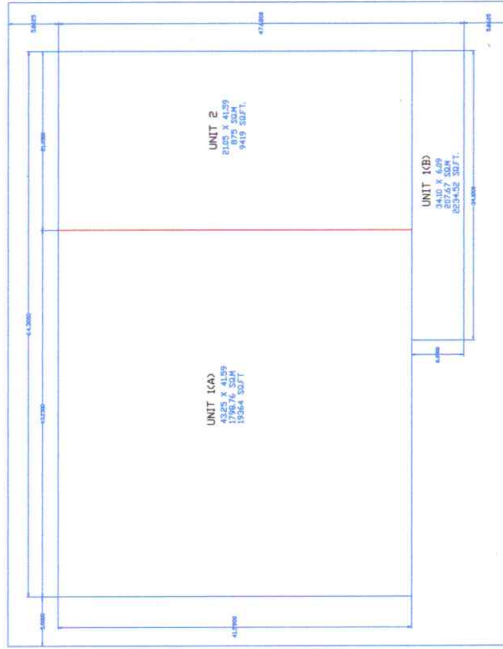

AREA CALCULATION

UNIT	SQM	SQFT
UNIT 1 (A)	1797.76	19564.00
UNIT 1 (B)	1234.52	13345.52
UNIT 2	1797.76	19419.00
TOTAL AREA	28620	310000

PROPOSED LAYOUT OF SHREE AGRO FPC AT DAHIWADI

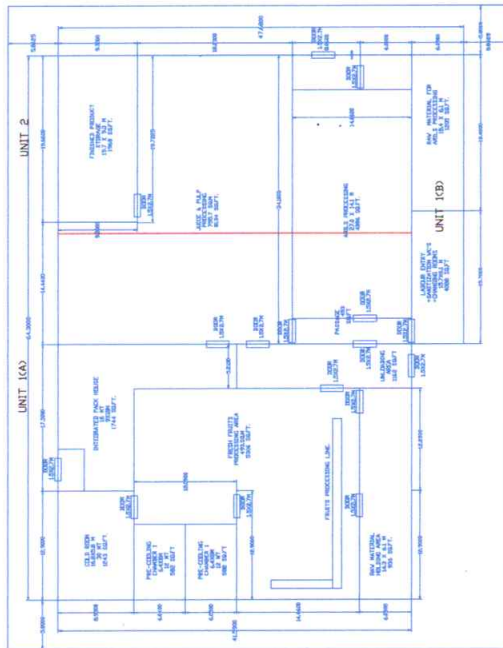

Er. VISHAL S. GHORPADE
Civil Engineer & Govt. Contractor
A/p. Dahiwadi Tal. Man, Dist. Satara
P.W.D. Reg. No. 69/2017/2018
Mo. 9421144411/943144411

॥श्री॥

विशाल शिवाजी घोरपडे (बी.ई. सिव्हिल)

सिव्हिल इंजीनियर अँड गव्हर्नमेंट कॉन्ट्रक्टर

पत्ता : मु. पो. दहिवाडी, एम.एस.सी.बी. शेजारी ता. माण, जि. सातारा. फोन नं.: ९४२११४४४११

[Email ID: vishalraje4411@gmail.com] GSTIN : 27BVPPG8441N1ZU

Ref. No. : 69/2017-2018 P.W.D

दिनांक: 20/09/2023

Recapitulation Sheet Format

Sub work 1) Civil Work of Cold Storage – 30 Mt, Pre-Cooling Chamber Unit No. 1 - 12 Mt, Pre-Cooling Chamber unit No. 2 - 12 Mt Each and Integrated Pack House 16 MT (9*18)	Rs. 1,65,20,000.00
Sub work 2) Civil Work of Processing shed	Rs. 64,37,700.00
Sub Work 3) Electric Work for Integrated Pack House and Processing unit	Rs. 12,60,000.00
Sub work 5) Royalty charge	Rs. 66,700.00
Sub work 6) Material Lab Testing Charges	Rs. 93,600.00
Total Cost Rs. 1+2+3+4+5+6	Rs. 2,43,78,000.00
Add	
7) GST 12 % From (A)	Rs. 29,25,360.00
8) Labour Insurance 0.5 % From (A)	Rs. 1,21,890.00
Grand Total Rupees	Rs. 2,74,25,250.00

Vishal
20/09/23
For Bank purpose.

Er.VISHAL S.GHORPADE
Civil Engineer & Govt.Contractors
A/p.Dahiwadi Tal.Man,Dist.Satara
PWD.Reg.No.69/2017/2018
Mo.9421144411/943144411

ESTIMATION AND COSTING

SHREE AGRO INDUSTRIES (PROP.MR.SAGAR UTTAM GHORPADE)

SHREE AGRO KRUSHI FARMERS PRODUCER COMPANY LTD.

A/P DAHIWADI,TAL-MAN

DIST -SATARA 415508

Unit 1 =2006.03 SQ.M

Sr. No.	Description	Qty	Unit	Rate	Amount
1	Excavation for foundation in earth, soil of all types, sand, gravel and soft murum, including removing the excavated material up to a distance of 50 m. beyond the building area & stacking and spreading as directed, dewatering, preparing the bed for the foundation and necessary back filling, ramming, watering including shoring and strutting etc. complete. (Lift upto 1.5 m.)	280.670	M3	175.00	49117.25
2	Excavation for foundation in hard murum including removing the excavated materials upto distance of 50 metres beyond the building area and stacking and spreading as directed, dewatering, preparing the bed for the foundation and necessary back filling, ramming, watering including shoring and strutting etc. complete. (Lift upto 1.50 m)	150.890	M3	185.00	27914.65
3	Excavation for foundation in Hard rock by blasting including trimming and leveling the bed by chiseling where necessary and removing the excavated materials and stacking it in measurable heaps within a distance of 50 metres from the building area including dewatering and back filling with available earth murum watering ramming, complete.	55.460	M3	760.00	42149.60

4	Providing uncoursed rubble masonry of trap/granite /quartzite /gneiss stones in cement mortar 1:6 in foundations and plinth of inner walls/in plinth of external walls including bailing out water, striking complete.	90.23	M3	2650.00	239109.50
5	Filling in plinth and floors with approved excavated materials in 15 cm to 20 cm layers including watering and compaction complete.	1963	M3	65.00	127595.00
6	Filling in plinth and floors with contractors soil sand or murum in 15 cm to 20cm, layers including watering and compaction complete.	1523.30	M3	283.00	431093.90
7	Providing dry/ trap/ granite/ quartzite/ gneiss rubble stone soiling 15 cm to 20 cm thick including hand packing and compacting complete.	369.320	M3	835.00	308382.20
8	Providing and laying in situ, cement concrete 1:4:8 in M-10 of trap/ granite/ quartzite/ gneiss metal for foundation and bedding including bailing out water, formwork, compacting and curing complete	333.600	M3	3550.00	1184280.00
9	Providing and laying in situ cement concrete M-20 of trap / granite /quartzite/ gneiss metal for R.C.C. work in foundations like raft, strip foundations, grillage and footings of R.C.C. columns and steel stanchions etc. including bailing out water, formwork, cover blocks compaction and curing roughening the surface if special finish is to be provided. (Excluding reinforcement & structural steel) complete.	78.900	M3	4895.00	386215.50
10	Providing and laying in situ cement concrete M-20 of trap / granite /quartzite/ gneiss metal for R.C.C. work in columns as per detailed designs & drawing including formwork, cover blocks compaction and curing roughening the surface if special finish is to be provided (Excluding reinforcement and structural steel) complete . With natural sand.	23.300	M3	9325.00	217272.50

11	Providing and casting in situ cement concrete in M-25 of trap/ granite/ quartzite/ gneiss metal for R.C.C. beams and lintels as per detailed designs and drawings or as directed including centering, formwork, cover blocks compaction and roughening the surface if special finish is to be provided and curing complete.	39.900	M3	8305.00	331369.50
12	Providing and casting in situ cement concrete in M-25 of trap/ granite/ quartzite/ gneiss metal for R.C.C. Chajja as per detailed designs and drawings or as directed including centering, formwork, cover blocks compaction and roughening the surface if special finish is to be provided and curing complete.	12.900	M3	8605.00	111004.50
13	Providing and laying in situ cement concrete M25 of 200 mm Thick trap/ granite/ quartzite gneiss metal for RCC work for Floor etc. including bailing out water, formwork compaction curing etc complete. (Excluding reinforcement, & structural steel)	148.900	M3	6950.00	1034855.00
14	Providing and applying Tremix treatment to the cement concrete floor comprising of screed vibrating and levelling of concrete surface, vacuum dewatering, bull floating and striking off, power floating and power trowelling, curing by ponding for 14 days, cleaning, including Groove cutting etc. complete.(The tremix concrete surface to be thoroughly cleaned with washing, manual scraping of all the adhered dust, after the curing is over And the concrete surface should be completely dry)	998.000	M2	165.00	164670.00
15	Providing and fixing in position HYSD steel bar reinforcement of various diameters for RCC Pile, Caps, Footings, Foundations, Slabs, Beams, coloums, chajjas, lintels, Pardi etc as per details designs, drawings and schedules the bars binding with wires or tack welding and supporting as required complete.	39.100	M.T.	50660.00	1980806.00

16	Providing second class Burnt Brick masonry with conventional/ I.S. type bricks in cement mortar 1:6 in superstructure including striking joints, racking out joints, watering and scaffolding complete.	368.900	M3	4930.00	1818677.00
17	Providing and fixing teakwood for doors and window frame of 100mm x 60mm x 1.2mm thick including necessary holdfast, hinges, tie rods including anti corrosive treatment like phosphating & zinc chromate primer coat. All complete as per drawing & specifications.	207.800	M2	428.00	88938.40
18	Providing and fixing steel window of various sizes as per detailed drawing without hot dip zinc coating, without ventilators, including fabricating / glazing with plain / obscured glass panels of approved type and quality, iron oxidised fixtures and fastenings, oil painting two coats complete.	34.900	M2	2893.00	100965.70
19	Providing and fixing rolling shutter fabricated from steel laths of minimum thickness 0.9 mm with lock plate of 3.15 mm thickness reinforced with 35 x 35 x 5 mm angle section fitted with sliding bolts and handles for both sides, deep M.S. channel section of depth and thickness not less than 65 mm and 3.15 mm respectively with hold fast arrangements, M.S. Bracket plate 300 x 300 x 3.15 mm minimum size and shape with square bar, suspension shaft of minimum 32 mm diameter, hood cover of M.S. sheet not less than 0.9 mm thickness and of any size at top and safety devices including mechanical gear operation arrangement consisting of worm gear wheels and worms of high grade cast iron or mild steel and one coat of red	79.050	M2	3685.00	291299.25
20	Providing internal cement plaster 6 mm thick in a single coat in cement mortar 1:4 without neeru finish to concrete & Brick surface in all positions including scaffolding and curing complete.	673.900	M2	282.00	190039.80

21	Providing sand faced plaster externally in cement mortar using approved screened sand, in all positions including base coat of 15 mm thick in cement mortar 1:4 using waterproofing compound at 1 kg per cement bag curing the same for not less than 2 days and keeping the surface of the base coat rough to receive the sand faced treatment 6 to 8 mm thick in cement mortar 1:4 finishing the surface by taking out grains and curing for fourteen days scaffolding etc.complete.	409.000	M2	398.00	162782.00
22	Providing structural steel work in trusses, other similar trussed purlins and members with all bracing, gusset plates etc. as per detailed designs and drawings or as directed including cutting, fabricating, hoisting, erecting fixing in position, Making riveted/ bolted/ welded connection and one coat of anticorrosive paint and over it 2 coats of oil painting complete.	50.320	M.T.	67000.00	3371440.00
23	Providing and fixing corrugated galvanised iron sheets of 0.80mm thick (22 B.W.G.) for roofing without wind tiles including fastening with galvanised / iron screw / bolt and lead / bitumen washers as per drawing complete.	750.000	M2	806.00	604500
24	Providing and applying Electrical work any labor or material used in installing, altering, maintaining, or extending an electrical wiring system and the appurtenances, apparatus, or equipment used in connection with the use of electrical energy in, on, outside, or attached to a building, residence, structure, property, or premises. The term includes service entrance conductors as defined by the National	759.5	M2	1315.60	999198.2
25	Providing and applying washable oil bound distemper for internal plastered surface of approved colour and shade to old and newsurface in two coats including scaffoldings, preparing the surface.(Excluding the primer coat) complete.	6500	M2	35.00	227500
Total Amount Rs					14491175.45
26	DRAINAGE, PLUMBING, FITTING	L.53%			434736.00

27	LIGHT FITTING AND ELECTRICITY	L.S3%	434736.00
28	WATER CHARGES	L.S3%	434736.00
29	BUILDING DRAWING, PLANING, SUPERVISION	L.S5%	724559.00
			16519940.00
TOTAL ESTIMATED COST UNIT 2			16520000.00

IN WORDS RUPEES One CRORE SIXTY FIVE LAKH TWENTY THOUSAND ONLY.

NAME OF OWNER=SHREE AGRO KRUSHI
FARMERS PRODUCER COMPANY LTD.

(Signature)
SIGN OF ENGINEER
20/06/2018
for bank purpose

Er.VISHAL S.GHORPADE
Civil Engineer & Govt.Contractors
A/p.Dahiwadi Tal.Man,Dist.Satara
PWD.Reg.No.69/2017/2018
Mo.9421144411/943144411

ESTIMATION AND COSTING

SHREE AGRO INDUSTRIES(PROP.MR.SAGAR UTTAM GHORPADE)

SHREE AGRO KRUSHI FARMERS PRODUCER COMPANY LTD.

GAT NO.216/B/1 DAHIWADI,TAL-MAN,DIST-SATARA 415508

UNIT 2= 875.26 SQ.M

Sr. No.	Description	Qty	Unit	Rate	Amount
1	Excavation for foundation in earth, soil of all types, sand, gravel and soft murum, including removing the excavated material up to a distance of 50 m. beyond the building area & stacking and spreading as directed, dewatering, preparing the bed for the foundation and necessary back filling, ramming, watering including shoring and strutting etc. complete. (Lift upto 1.5 m.)	125	M3	175.00	21875.00
2	Excavation for foundation in hard murum including removing the excavated materials upto distance of 50 metres beyond the building area and stacking and spreading as directed, dewatering, preparing the bed for the foundation and necessary back filling, ramming, watering including shoring and strutting etc. complete. (Lift upto 1.50 m)	63.000	M3	185.00	11655.00
3	Excavation for foundation in Hard rock by blasting including trimming and leveling the bed by chiseling where necessary and removing the excavated materials and stacking it in measurable heaps within a distance of 50 metres from the building area including dewatering and back filling with available earth murum watering ramming, complete.	35.800	M3	760.00	27208.00
4	Providing uncoursed rubble masonry of trap/granite /quartzite /gneiss stones in cement mortar 1:6 in foundations and plinth of inner walls/in plinth of external walls including bailing out water, striking complete.	75.6	M3	2650.00	200340.00

5	Filling in plinth and floors with approved excavated materials in 15 cm to 20 cm layers including watering and compaction complete.	1380	M3	65.00	89700.00
6	Filling in plinth and floors with contractors soil sand or murum in 15 cm to 20cm, layers including watering and compaction complete.	890.00	M3	283.00	251870.00
7	Providing dry/ trap/ granite/ quartzite/ gneiss rubble stone soiling 15 cm to 20 cm thick including hand packing and compacting complete.	235.000	M3	835.00	196225.00
8	Providing and laying in situ, cement concrete 1:4:8 in M-10 of trap/ granite/ quartzite/ gneiss metal for foundation and bedding including bailing out water, formwork, compacting and curing complete	241.000	M3	3550.00	855550.00
9	Providing and laying in situ cement concrete M20 of trap / granite /quartzite/ gneiss metal for R.C.C. work in foundations like raft, strip foundations, grillage and footings of R.C.C. columns and steel stanchions etc. including bailing out water, formwork, cover blocks compaction and curing roughening the surface if special finish is to be provided. (Excluding reinforcement & structural steel) complete.	42.850	M3	4895.00	209750.75
10	Providing and laying in situ cement concrete M-20 of trap / granite /quartzite/ gneiss metal for R.C.C. work in columns as per detailed designs & drawing including formwork, cover blocks compaction and curing roughening the surface if special finish is to be provided (Excluding reinforcement and structural steel) complete . With natural sand.	15.110	M3	9325.00	140900.75

11	Providing and casting in situ cement concrete in M-25 of trap/ granite/ quartzite/ gneiss metal for R.C.C. beams and lintels as per detailed designs and drawings or as directed including centering, formwork, cover blocks compaction and roughening the surface if special finish is to be provided and curing complete.	15.110	M3	8305.00	129998.17
12	Providing and casting in situ cement concrete in M-25 of trap/ granite/ quartzite/ gneiss metal for R.C.C. Chajja as per detailed designs and drawings or as directed including centering, formwork, cover blocks compaction and roughening the surface if special finish is to be provided and curing complete.	2.607	M3	8605.00	22433.24
13	Providing and laying in situ cement concrete M25 of 200 mm Thick trap/ granite/ quartzite gneiss metal for RCC work for Floor etc. including bailing out water, formwork compaction curing etc complete. (Excluding reinforcement, & structural steel)	40.900	M3	6950.00	284255.0
14	Providing and applying Tremix treatment to the cement concrete floor comprising of screed vibrating and levelling of concrete surface, vacuum dewatering, bull floating and striking off, power floating and power trowelling, curing by ponding for 14 days, cleaning, including Groove cutting etc. complete.(The tremix concrete surface to be thoroughly cleaned with washing, manual scraping of all the adhered dust, after the curing is over And the concrete surface should be completely dry)	400.00	M2	165.00	66000.00

15	Providing and fixing in position HYSD steel bar reinforcement of various diameters for RCC Pile, Caps, Footings, Foundations, Slabs, Beams, coloums, chajjas, lintels, Pardi etc as per details designs, drawings and schedules the bars binding with wires or tack welding and supporting as required complete.	4.200	M.T.	50660.00	212772.00
16	Providing second class Burnt Brick masonry with conventional/ I.S. type bricks in cement mortar 1:6 in superstructure including striking joints, racking out joints, watering and scaffolding complete.	95.230	M3	4930.00	469483.90
17	Providing and fixing teakwood for doors and window frame of 100mm x 60mm x 1.2mm thick including necessary holdfast, hinges, tie rods including anti corrosive treatment like phosphating & zinc chromate primer coat. All complete as per drawing & specifications.	98.705	M2	428.00	42245.74
18	Providing and fixing steel window of various sizes as per detailed drawing without hot dip zinc coating, without ventilators, including fabricating / glazing with plain / obscured glass panels of approved type and quality, iron oxidised fixtures and fastenings, oil painting two coats complete.	14.500	M2	2893.00	41948.50

19	Providing and fixing rolling shutter fabricated from steel laths of minimum thickness 0.9 mm with lock plate of 3.15 mm thickness reinforced with 35 x 35 x 5 mm angle section fitted with sliding bolts and handles for both sides, deep M.S. channel section of depth and thickness not less than 65 mm and 3.15 mm respectively with hold fast arrangements, M.S. Bracket plate 300 x 300 x 3.15 mm minimum size and shape with square bar, suspension shaft of minimum 32 mm diameter, hood cover of M.S. sheet not less than 0.9 mm thickness and of any size at top and safety devices including mechanical gear operation arrangement consisting of worm gear wheels and worms of high grade cast iron or mild steel and one coat of red lead primer etc. complete.	19.500	M2	3685.00	71857.50
20	Providing internal cement plaster 6 mm thick in a single coat in cement mortar 1:4 without neeru finish to concrete & Brick surface in all positions including scaffolding and curing complete.	148.500	M2	282.00	41877.00
21	Providing sand faced plaster externally in cement mortar using approved screened sand, in all positions including base coat of 15 mm thick in cement mortar 1:4 using waterproofing compound at 1 kg per cement bag curing the same for not less than 2 days and keeping the surface of the base coat rough to receive the sand faced treatment 6 to 8 mm thick in cement mortar 1:4 finishing the surface by taking out grains and curing for fourteen days scaffolding etc.complete.	26.900	M2	398.00	10706.20

22	Providing structural steel work in trusses, other similar trussed purlins and members with all bracing, gusset plates etc. as per detailed designs and drawings or as directed including cutting, fabricating, hoisting, erecting fixing in position, Making riveted/ bolted/ welded connection and one coat of anticorrosive paint and over it 2 coats of oil painting complete	23.430	M.T.	67000.00	1704402.00
23	Providing and fixing corrugated galvanised iron sheets of 0.80mm thick (22 B.W.G.) for roofing without wind tiles including fastening with galvanised / iron screw / bolt and lead / bitumen washers as per drawing complete.	270.00	M2	806.00	217620
24	. providing and applying Electrical work any labour or material used in installing, altering, maintaing or extending an electrical wiring system and the appurtenances or equipment used in connection with the use of electrical energy in,on, outside or attached to a building, residence, structure, property or premises. The term including service entrance conductors as defined by the National .	240.00	M2	1315.60	315744.00
26	Providing and applying washable oil bound distemper for internal plastered surface of approved colour and shade to old and newsurface in two coats including scaffoldings, preparing the surface.(Excluding the primer coat) complete.	305.23	M2	35.00	10683.05
Total Amount Rs					5647100.79
27	DRAINAGE,PLUMBING,FITTING	L.S3%			169413.00
28	LIGHT FITTING AND ELETRICITY	L.S3%			169413.00
29	WATER CHARGES	L.S3%			169413.00
30	BUILDING DRAWING,PLANING,SUPERVISION	L.S5%			282355.00
TOTAL ESTIMATED COST G.F UNIT 2 (RS.)					6437694.00
Say					RS.6437700/-

In Words- Rupees Sixty Four Lakh Thirty Seven Thousand Seven Hundred Only .

Vishal S.G. for bank purpose
Er. VISHAL S. GHORPAL
Civil Engineer & Govt. Contractor
A/p. Dahiwadi Tal. Man. Dist. Sat.
PWD. Reg. No. 69/2017/2018
Mo. 9421144411/943144411

NAME OF OWNER=SHREE AGRO KRUSHI FARMERS
PRODUCER COMPANY LTD.

SIGN OF
ENGINEER