



KISAN SAMAJ AGRI PRODUCER COMPANY LIMITED



REGISTRATION NO. 1312239

MEMBER ID: 413512

Date: 16/12/20



भा. प्रकल्प संचालक, आत्मा

जिल्हा - सातुर

विषय :- मान्यता मिळालेल्या स्वयंचलित दाळमिल प्रकल्पाचे अंदाजपत्रक व दरपत्रकास सुधारित मान्यता मिळणे बाबत.

महोदय,

उपरोक्त विषयान्वये विनंती करतो कि, मान्यता प्राप्त प्रकल्प उभारणीमध्ये स्वयंचलित दाळमिल मशिनरी आरण्यास अडचण निर्माण होत असल्या कारणाने दाळमिल शेडचे सुधारित -अंदाजपत्रक व स्वयंचलित मशिनरी, स्टोरेज टँक, प्लॅटफॉर्म चे -दरपत्रक सादर करीत आहेत. पुर्वीचे अंदाज पत्रक हे गोंदास उभारण्याच्या अनुषंगाने बनवले होते. व सदरील अंदाजपत्रक इंटरस्ट्रीयल शेड बनवण्याच्या दृष्टीने बनवले आहे. व अंदाज पत्रकात मशिनरी आरणीच्या अनुषंगाने सर्व बदल करून बनवण्यात आले आहे.

पुर्वीचे मशिनरी चे दरपत्रक व नवीन दरपत्रक यांमध्ये असणारा बदल खालील प्रमाणे :

Sr. No.	Particulars	पुर्वीचे दरपत्रकातील नग	सुधारित दरपत्रकाचे नग
1	Drume Seive	1	3
2	Vibro Classfire	5	-
3	Drume Seive	-	5
4	De stonner	1	1
5	Fataka Machine	1	1
6	Dal polisher	2	6
7	Aspiration channel	6	10
8	Oil machine	1	-
9	Chakki	1	-
10	Buket elevator	1150 feet	1115 feet
11	Screw conveyer	8	11

DETAILED ESTIMATE

(AS PER PWD SSR 2022 23)

FOR

KETKISANGAMI AGRO PRODUCER COMPANY LTD.

TOTAL AMOUNT (Rs.) = 86.53 LAKHS

* NAME OF WORK *

PROPOSED CONSTRUCTION OF INDUSTRIAL SHED IN GUT
NO. 131, AT HASEGAON, TQ AUSA, DIST. LATUR.

Ketkisangami
S. S. Pangave

(B.E. CIVIL)

Consulting Civil Engineer
T. P. Latour / 643 / 2019
Mob. 8552085000

CONSULTANT



KETKISANGAM AGRO PRODUCER COMPANY LTD.

NAME OF WORK PROPOSED CONSTRUCTION OF INDUSTRIAL SHED IN GUT NO. 131, AT
HASEGAON, TQ AUSA, DIST. LATUR

RECAPITULATION SHEET

Sr. No.	PARTICULARS	AREA	UNIT	Amount (Rs.)
1	Cost of Shed	446.88	SQM	7279579.00
3	Add Royalty Charges			93585.91
4	Add Material lab testing charges			23205.00
	Total			7396369.91
5	Add 12 % GST			887564.39
6	Add 0.5 % Labour Insurance			369818.50
	Grand Total			8653752.79

Pangave

S. S. Pangave

(B.E. CIVIL)

Consulting Civil Engineer

T. P. Latur / 643 / 2019

Mob. 8552085000



PROPOSED CONSTRUCTION OF INDUSTRIAL SHED IN GUT NO. 131, AT HASEGAON, TQ. AUSA, DIST. LATUR

MEASUREMENT SHEET.

SIR. NO.	DESCRIPTION OF ITEM	NO.	L	B	D	QTY.	
1	Excavation for foundation in earth, soil of all types, sand, gravel and soft murum, including removing the excavated (S.S.R. OF 2022-23 I No. 21.02 P.No. 115) FOR COLUMN FOOTING	22	1.50	1.50	0.300	14.850	
		6	4.00	2.00	0.300	19.200	
		TOTAL QUANTITY					34.050
							Cu.M.
2	Excavation for foundation in hard murum including removing the excavated material upto distance of 50 metres (S.S.R. I No. 21.06 P.No. 115) FOR COLUMN FOOTING, FOR STEPS	22	1.50	1.50	0.300	14.850	
		6	4.00	2.00	0.300	19.200	
		TOTAL QUANTITY					34.050
							Cu.M.
3	Providing and laying Cast in situ/Ready Mix cement concrete in M 10 of trap/ granite/ quartzite/ gneiss metal for foundation and bedding including bedding and water. (S.S.R. I No. 24.01 P.No. 131) FOR COLUMN FOOTING, FOR STEPS, FOR GODOWN	22	1.20	1.20	0.075	2.376	
		6	3.90	1.20	0.075	2.808	
		1	36.60	12.21	0.075	33.516	
		TOTAL QUANTITY					38.700
					Cu.M.		
4	Providing and laying in situ/Ready Mix cement concrete M-20 of trap/ granite/quartzite/gneiss metal for R.C.C. work in foundations like raft, strip foundations, grillage and footings of R.C.C. columns and steel structures also including bedding (S.S.R. I No. 25.11, P.No. 133) FOR COLUMN FOOTING,	22	1.50	1.50	0.300	14.850	
		TOTAL QUANTITY					14.850
							Cu.M.
5	Providing and laying Cast in situ /Ready Mix cement concrete M20 of trap /granite/quartzite/gneiss metal for R.C.C. columns as per detailed designs and drawing of as (S.S.R. I No. 25.31, P.No. 134) FOR COLUMN FOOTING TO PLINTH FOR COLUMN ABOVE PLINTH	22	0.60	0.75	2.150	21.285	
		6	0.23	0.45	3.350	0.000	
		TOTAL QUANTITY					21.285
							Cu.M.
6	Providing and laying Cast in situ /Ready Mix cement concrete M20 of trap/granite/quartzite/gneiss metal for R.C.C. beams and lintels as per detailed designs and (S.S.R. I No. 25.50, P.No. 135) GROUND LEVEL LONG WALL SHORT WALL PLINTH LEVEL LONG WALL SHORT WALL	16	3.90	0.23	0.450	6.458	
		6	3.17	0.23	0.450	1.969	
		16	3.90	0.23	0.150	2.153	
		6	3.17	0.23	0.150	0.656	
TOTAL QUANTITY					11.236		
					Cu.M.		
7	Providing and laying Cast in situ/Ready Mix cement concrete M-20 of trap/ granite/ quartzite/ gneiss metal for R.C.C. PARDI as per detailed design and drawings including (S.S.R. I No. 26.17, P.No. 137) STEPS SIDE	6	0.15	0.15	1.650	0.000	
		TOTAL QUANTITY					0.000
							Cu.M.

MEASUREMENT SHEET.

Sl. No.	DESCRIPTION OF ITEM	NO.	L	B	D	QTY.
8	Providing and laying Cast in situ /Ready Mix cement concrete M20 of trap/granite/ quartzite/gneiss metal for R.C.C. slab sand landings as per detailed designs and (S.S.R. I No. 25.70, P.No. 135)	4	5.170	1.200	0.10	2.482
	GROUND FLOOR					2.482
	RAMP					Cu.M.
	TOTAL QUANTITY					
9	Providing and laying Cast in situ /Ready Mix cement concrete M20 of trap/granite/quartzite/gneiss metal for R.C.C. Chatta as per detailed designs and drawings including (S.S.R. I No. 26.05, P.No. 137)	0	1.50	0.60	0.100	0.000
	VENTILATOR CHAJJA					0.000
	TOTAL QUANTITY					Cu.M.
10	Providing and fixing in position TMT FE 500 bar reinforcement of various diameters for R.C.C. pile caps, (S.S.R. I No. 26.33, P.No. 139)	14.85	cum. @	60.00	kg/cum	891.000
	Footing	21.29	cum. @	70.00	kg/cum	1489.950
	Column	11.24	cum. @	70.00	kg/cum	786.520
	Beam	0.00	cum. @	60.00	kg/cum	0.000
	Pandi & Chajja	2.40	cum. @	60.00	kg/cum	144.920
	Slab				TOTAL	3316.39
						KG
	TOTAL QUANTITY					3.316
						M.T.
11	Providing soiling using 80mm, size trap metal in 15cm. layer including filling voids with crushed sand/grit, ramming, (S.S.R. I No. 21.40 P.No. 118)	0	36.14	11.75	0.150	0.000
	BELOW FLOORING					0.000
	TOTAL QUANTITY					CUM
12	Filling in plinth and floors with contractor material/ brought from out side and approved by Engineer incharge in layers (S.S.R. I No. 21.37, P.No. 117)	1	36.14	11.75	0.900	382.181
	BELOW FLOORING					382.181
	TOTAL QUANTITY					Cu.M.
13	Providing masonry with conventional / Indian Standard type bricks in cement mortar 1:6 in foundation and plinth of inner walls / in plinth of external walls including bailing out (S.S.R. I No. 27.01, P.No.144)	16	3.90	0.23	0.900	12.917
	LONG WALL	6	3.17	0.23	0.900	3.937
	SHORT WALL					16.854
	TOTAL QUANTITY					Cu.M.
14	Providing masonry with conventional / Indian Standard type bricks in cement mortar 1:6 in superstructure including striking joints, raking out joints, watering and scaffolding (S.S.R. I No. 27.05, P.No. 144)	0	2.94	0.23	3.350	0.000
	LONG WALL	0	2.65	0.23	3.350	0.000
	SHORT WALL	0	1.50	0.23	0.600	0.000
	DEDUCTIONS FOR VENTILATORS	0	2.94	0.23	2.900	0.000
	DEDUCTIONS FOR SHUTTER					0.000
	TOTAL QUANTITY					Cu.M.
15	Providing internal cement plaster 6 mm thick in a single coat in cement mortar 1:4 without neeru finish to concrete surfaces in all positions including scaffolding and extra etc. (S.S.R. I No. 32.01, P.No. 153)					

MEASUREMENT SHEET,

Sl. No.	DESCRIPTION OF ITEM	NO.	L	B	D	QTY.
	FOR CHAJIAS	0	1.50	0.60		0.000
	TOTAL QUANTITY					0.000
	Sq. M.					
16	Providing internal cement plaster 20 mm thick in single coat in cement mortar 1:5 without neery finish to concrete or brick surfaces, in all positions including scaffolding and (S.S.R. I No. 32.01 P. No. 151)	0	16.54		3.350	0.000
	LONG WALL	0	9.79		3.350	0.000
	SHERT WALL	0	1.50		0.600	0.000
	DEDUCTIONS FOR VENTILATOR	0	1.50		2.900	0.000
	DEDUCTIONS FOR SHUTTER	0	2.94			0.000
	TOTAL QUANTITY					0.000
	Sq. M.					
17	Providing sand faced plaster externally in cement mortar using approved screened sand, in all positions including base coat of 13.0mm thick in cement mortar 1:4:8 and (S.S.R. I No. 32.11 P. No. 151)	7	16.60		0.900	65.880
	BELOW PLINTH	7	16.60		0.900	65.880
	LONG WALL	7	17.21		1.200	29.304
	SHERT WALL					95.184
	TOTAL QUANTITY					54.000
	Sq. M.					
18	Providing and laying in situ cement concrete M20 with brisna treatment for 100 mm thickness for flooring with minimum thickness of 40mm, and 20mm, from slab. (S.S.R. I No. 33.30 P. No. 150)	1	26.60	12.21		446.886
	FOR GROUND	1	26.60	12.21		446.886
	TOTAL QUANTITY					50M
	SQM					
19	Providing and fixing in position powder coated aluminium louvered windows / ventilator of various sizes with powder (S.S.R. I No. 39.60 P. No. 180)	66	1.00		0.600	39.60
	VENTILATOR 1	18	0.60		0.600	6.480
	VENTILATOR 2					46.080
	TOTAL QUANTITY					54.000
	Sq. M.					
20	Providing and fixing corrugated galvanised iron sheets of 0.6mm thick (24 B W G.) for roofing without wind tiles (S.S.R. I No. 38.05 P. No. 171)	1	2.00	36.60	7.42	543.144
	FOR ROOFING	2	36.60		12.19	892.308
	LONG SIDE	2	12.21		12.190	297.680
	SHORT SIDE					1733.132
	TOTAL QUANTITY					1733.132
	Sq. M.					
21	Providing and fabricating structural steel work in rolled sections like joists, channels, angles, tees etc. as per (S.S.R. I No. 23.02 P. No. 129)	1733.13	SQ. M.	15.18	KG/SQ. M.	26308.944
	FOR TRUSS, ANGLE, GIRDER					KG
	TOTAL QUANTITY					26.309
	MT. T.					
22	Providing and fixing rolling shutter fabricated from steel laths of minimum thickness 0.9mm with lock plate of (S.S.R. I No. 39.25 P. No. 164)	4	2.90	3.65		56.940
	OPENING	4	2.90	3.65		56.940
	TOTAL QUANTITY					56.940
	Sq. M.					
23	Royalty					
	a) Royalty Charges for sand					46.198
	b) Royalty Charges for other minerals					382.181
	As per statement attached					46.198
	As per statement attached					382.181
						428.379

S. S. Pangave
 Consulting Civil Engineer
 (B.E. CIVIL)
 T. P. Latour / 643 / 2019
 Mob. 8562085000

PROJECT NO. 100000
 DATE: 10/10/2019
 SCALE: 1:100
 SHEET NO. 1 OF 1

REVISIONS

NO.	REVISION	DATE
01	ISSUED FOR PERMIT	10/10/2019
02	FOR APPROVAL	10/10/2019
03	FOR APPROVAL	10/10/2019

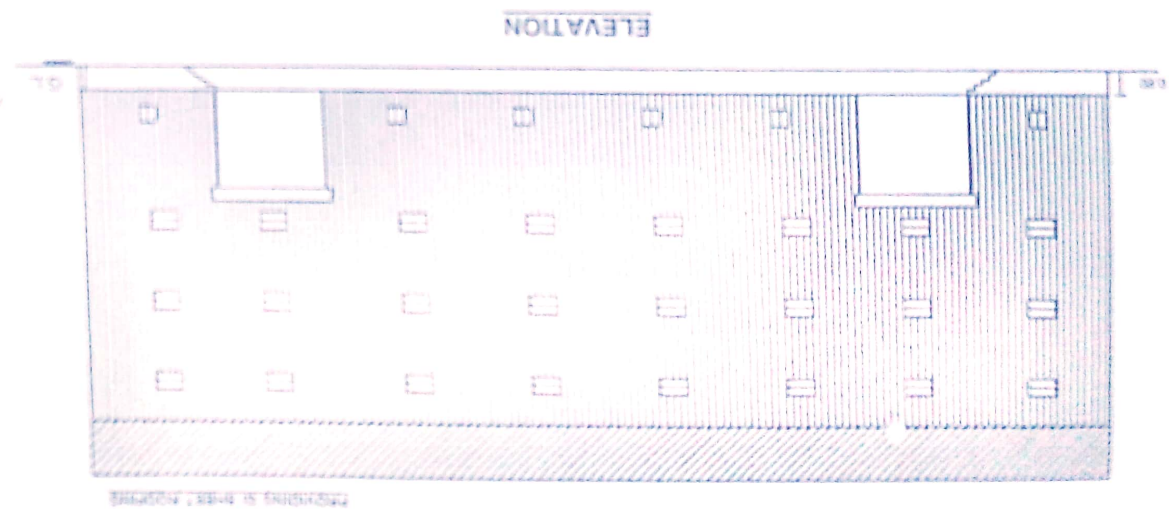
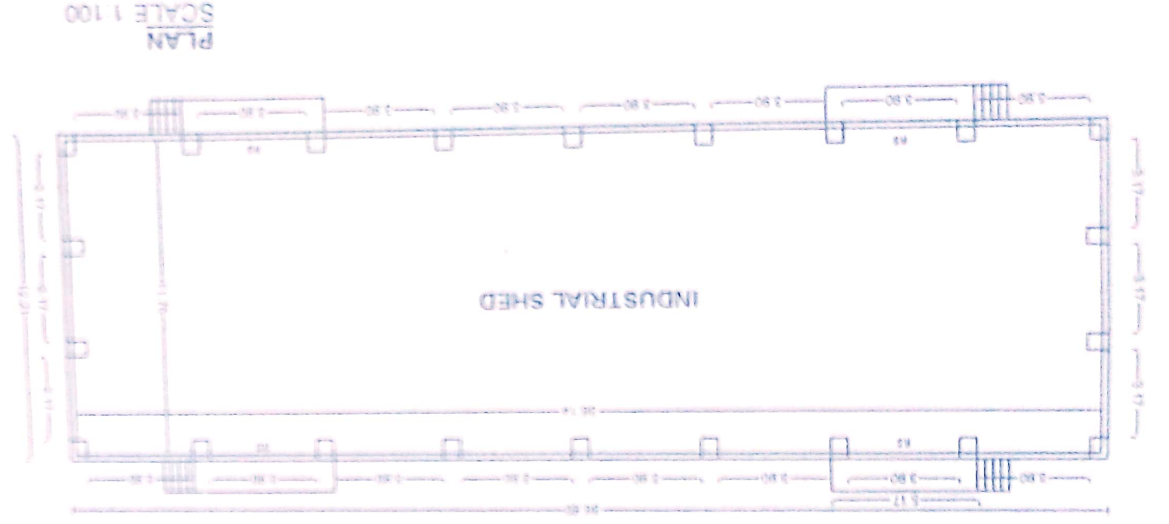
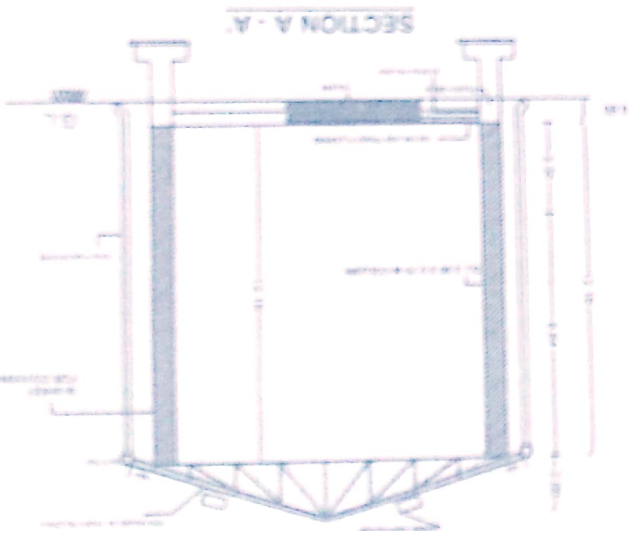
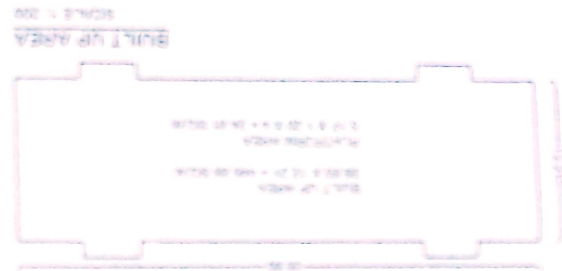
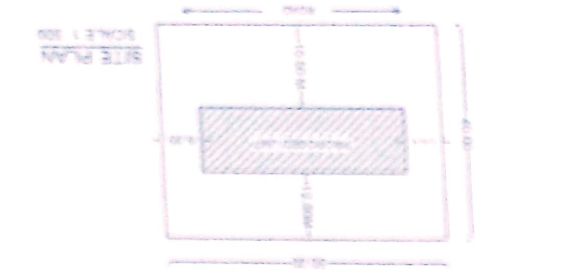

MEASUREMENT SHEET.

SIR. NO.	DESCRIPTION OF ITEM	NO.	L	B	D	QTY.
24	Laboratory test of construction material					0.000
	1) BASIC TEST OF AGGREGATE					
	a) Water Absorption, Specific Gravity, Impact Value, Crushing Value.	1.00				1.000
	b) Sieve Analysis	1.00				1.000
	c) Abrasion Value	1.00				1.000
	d) Flakiness Index & Elongation Index	1.00				1.000
	2) BRICKS					
	Water Absorption (Set of 5 Bricks), Compressive Strength (Set of 5 Bricks), Effluorescence (Set of 5 Bricks)	1.000				1.000
	3) CONCRETE					
	a) Compressive Strength OF C. C. Cube (Test of 3 cubes).	1.000				1.000
	b) Concrete Mix Design (With all tests on basic materials)	1.000				1.000
	4) STEEL					
	Steel bar testing upto 15 mm (set of 3 bars) (Tensile strength, %, Elongation, Yield Stress, Weight per meter, Bend, / Rebound Test, Proof Stress.)	1.000				1.000

PROPOSED CONSTRUCTION OF INDUSTRIAL SHED IN GUT NO. 131, AT HASEGAON, TQ. AUSA, DIST. LATUR

ABSTRACT

SR. N O.	DESCRIPTION OF ITEM	QUANTITY	RATE	UNIT	TOTAL AMOUNT
1	Excavation for foundation in earth, soil of all types, sand, gravel and soft murum, including removing the excavated material up to a distance of 50 m. beyond the building area & (S. S. R. OF 10.22.23 I. No. 21.02 P. No. 117) RATE ANALYSIS	136.200	207.00	Cu.M.	28193.00
2	Excavation for foundation in hard murum including removing the excavated material upto distance of 50 metres beyond the building area and stacking and spreading as directed, dewatering, preparing the bed for the foundation and (S. S. R. I. No. 24.01 P. No. 131) RATE ANALYSIS	34.050	227.00	Cu.M.	7729.00
3	Providing and laying Cast in situ/Ready Mix cement concrete in M-10 of trap/granite/quartzite/gneiss metal for foundation and beddings on ballast ballast and water framework (S. S. R. I. No. 24.01 P. No. 131) RATE ANALYSIS	18.700	7386.24	Cu.M.	205847.00
4	Providing and laying in situ/Ready Mix cement concrete M-20 of trap/granite/quartzite/gneiss metal for R.C.C. work in foundations like raft, strip foundations, grillage and footings of R.C.C. columns and steel structures etc. including ballast and (S. S. R. I. No. 25.11, P. No. 132) RATE ANALYSIS	14.850	8459.16	Cu.M.	125619.00
5	Providing and laying Cast in situ/Ready Mix cement concrete M-20 of trap/granite/quartzite/gneiss metal for R.C.C. columns as per detailed designs and drawings or as directed including (S. S. R. I. No. 25.21, P. No. 134) RATE ANALYSIS	21.283	15188.98	Cu.M.	323297.00
6	Providing and laying Cast in situ/Ready Mix cement concrete M-20 of trap/granite/quartzite/gneiss metal for R.C.C. beams and lintels as per detailed designs and drawings or as directed (S. S. R. I. No. 25.50, P. No. 135) RATE ANALYSIS	11.236	13971.50	Cu.M.	156984.00
7	Providing and laying Cast in situ/Ready Mix cement concrete M-20 of trap/granite/quartzite/gneiss metal for R.C.C. PARDEE as per detailed design and drawings including centering (S. S. R. I. No. 26.17, P. No. 137) RATE ANALYSIS	0.000	17269.50	Cu.M.	0.00
8	Providing and laying Cast in situ/Ready Mix cement concrete M-20 of trap/granite/quartzite/gneiss metal for R.C.C. slab sand landings as per detailed designs and drawings including centering, formwork, cover blocks, laying/pumping, compaction (S. S. R. I. No. 25.70, P. No. 135) RATE ANALYSIS	2.482	15634.50	Cu.M.	38805.00
9	Providing and laying Cast in situ/Ready Mix cement concrete M-20 of trap/granite/quartzite/gneiss metal for R.C.C. Chajja as per detailed designs and drawings including centering, formwork, cover blocks, connections, curing, finishing (S. S. R. I. No. 26.05, P. No. 137) RATE ANALYSIS	0.000	15634.50	Cu.M.	0.00
10	Providing and fixing in position TMT-FE-500 bar reinforcement of various diameters for R.C.C. pile caps, footings, foundations, slabs, beams, columns, canopies, staircases, newells, chajjas, lintels, girders, copings, fins, arches etc. as per detailed (S. S. R. I. No. 26.33, P. No. 139) RATE ANALYSIS	3.316	90051.11	Cu.M.	298609.0

ABSTRACT

S/N	DESCRIPTION OF ITEM	QUANTITY	RATE	UNIT	TOTAL AMOUNT
11	Providing rolling using 60mm. size trap metal in 15cm. layer including filling voids with crushed sand/grit, ramming, watering etc complete. Spec no. As directed by Engineer in charge (S.S.R. I No. 21.40 P. No. 118) RATE ANALYSIS	0.000	1864.55	CUM	0.00
12	filling in plinth and floors with contractors material/ brought from out side and approved by Engineer incharge in layers of 15 cm to 20 cm including watering and compaction etc. Complete (Spec. No. B1.A.11 page No. 26.2) (S.S.R. I No. 21.27, P. No. 117) RATE ANALYSIS	382.181	1029.44	Cu.M.	393432.00
13	Providing masonry with conventional / Indian standard type bricks in cement mortar 1:6 in foundation and plinth of inner walls / in plinth of external walls including bailing out water. (S.S.R. I No. 27.01, P. No. 144) RATE ANALYSIS	16.854	9644.04	Cu.M.	162541.00
14	Providing masonry with conventional / Indian standard type bricks in cement mortar 1:6 in superstructure including striking joints, raking out joints, watering and scaffolding complete. (Spec. No. B1.G.5 page No. 21.2) (S.S.R. I No. 27.05, P. No. 144) RATE ANALYSIS	0.000	9884.03	Cu.M.	0.00
15	Providing internal cement plaster 6 mm thick in a single coat in cement mortar 1:4 without neers finish to concrete surface in all positions including scaffolding and curing etc. complete. (Spec. No. B1.L.1 Page No. 26.2) As Directed by Engineer incharge (S.S.R. I No. 32.01, P. No. 153) RATE ANALYSIS	0.000	256.09	Sq.M.	0.00
16	Providing internal cement plaster 20 mm thick in single coat in cement mortar 1:5 without neers finish to concrete or brick surfaces, in all positions including scaffolding and curing etc. complete. (Spec. No. B1.L.2 Page No. 26.2) (S.S.R. I No. 32.03 P. No. 153) RATE ANALYSIS	0.000	428.09	Sq.M.	0.00
17	Providing sand faced plaster externally in cement mortar using approved screened sand, in all positions including base coat of 15 mm thick in cement mortar 1:4 using waterproofing. (S.S.R. I No. 32.11 P. 153) RATE ANALYSIS	95.184	692.09	Sq.M.	65876.00
18	Providing and laying in situ cement concrete M20 with tremix treatment for 100 mm thickness for flooring with groove cutting of 4mm wide and 20mm deep with necessary filling with bitumen etc. complete. (S.S.R. I No. 33.30 P. 158) RATE ANALYSIS	446.886	860.78	Sq.M.	384671.00
19	Providing and fixing in position powder coated aluminium louvered windows / ventilator of various sizes with powder coating as per detailed drawing and specifications including <small>Abstracts, Formwork, B1.G.5, B1.L.1, 1.2, 2.2, 2.3, 2.4, 2.5, 2.6, 2.7, 2.8, 2.9, 3.0, 3.1, 3.2, 3.3, 3.4, 3.5, 3.6, 3.7, 3.8, 3.9, 4.0, 4.1, 4.2, 4.3, 4.4, 4.5, 4.6, 4.7, 4.8, 4.9, 5.0, 5.1, 5.2, 5.3, 5.4, 5.5, 5.6, 5.7, 5.8, 5.9, 6.0, 6.1, 6.2, 6.3, 6.4, 6.5, 6.6, 6.7, 6.8, 6.9, 7.0, 7.1, 7.2, 7.3, 7.4, 7.5, 7.6, 7.7, 7.8, 7.9, 8.0, 8.1, 8.2, 8.3, 8.4, 8.5, 8.6, 8.7, 8.8, 8.9, 9.0, 9.1, 9.2, 9.3, 9.4, 9.5, 9.6, 9.7, 9.8, 9.9, 10.0, 10.1, 10.2, 10.3, 10.4, 10.5, 10.6, 10.7, 10.8, 10.9, 11.0, 11.1, 11.2, 11.3, 11.4, 11.5, 11.6, 11.7, 11.8, 11.9, 12.0, 12.1, 12.2, 12.3, 12.4, 12.5, 12.6, 12.7, 12.8, 12.9, 13.0, 13.1, 13.2, 13.3, 13.4, 13.5, 13.6, 13.7, 13.8, 13.9, 14.0, 14.1, 14.2, 14.3, 14.4, 14.5, 14.6, 14.7, 14.8, 14.9, 15.0, 15.1, 15.2, 15.3, 15.4, 15.5, 15.6, 15.7, 15.8, 15.9, 16.0, 16.1, 16.2, 16.3, 16.4, 16.5, 16.6, 16.7, 16.8, 16.9, 17.0, 17.1, 17.2, 17.3, 17.4, 17.5, 17.6, 17.7, 17.8, 17.9, 18.0, 18.1, 18.2, 18.3, 18.4, 18.5, 18.6, 18.7, 18.8, 18.9, 19.0, 19.1, 19.2, 19.3, 19.4, 19.5, 19.6, 19.7, 19.8, 19.9, 20.0, 20.1, 20.2, 20.3, 20.4, 20.5, 20.6, 20.7, 20.8, 20.9, 21.0, 21.1, 21.2, 21.3, 21.4, 21.5, 21.6, 21.7, 21.8, 21.9, 22.0, 22.1, 22.2, 22.3, 22.4, 22.5, 22.6, 22.7, 22.8, 22.9, 23.0, 23.1, 23.2, 23.3, 23.4, 23.5, 23.6, 23.7, 23.8, 23.9, 24.0, 24.1, 24.2, 24.3, 24.4, 24.5, 24.6, 24.7, 24.8, 24.9, 25.0, 25.1, 25.2, 25.3, 25.4, 25.5, 25.6, 25.7, 25.8, 25.9, 26.0, 26.1, 26.2, 26.3, 26.4, 26.5, 26.6, 26.7, 26.8, 26.9, 27.0, 27.1, 27.2, 27.3, 27.4, 27.5, 27.6, 27.7, 27.8, 27.9, 28.0, 28.1, 28.2, 28.3, 28.4, 28.5, 28.6, 28.7, 28.8, 28.9, 29.0, 29.1, 29.2, 29.3, 29.4, 29.5, 29.6, 29.7, 29.8, 29.9, 30.0, 30.1, 30.2, 30.3, 30.4, 30.5, 30.6, 30.7, 30.8, 30.9, 31.0, 31.1, 31.2, 31.3, 31.4, 31.5, 31.6, 31.7, 31.8, 31.9, 32.0, 32.1, 32.2, 32.3, 32.4, 32.5, 32.6, 32.7, 32.8, 32.9, 33.0, 33.1, 33.2, 33.3, 33.4, 33.5, 33.6, 33.7, 33.8, 33.9, 34.0, 34.1, 34.2, 34.3, 34.4, 34.5, 34.6, 34.7, 34.8, 34.9, 35.0, 35.1, 35.2, 35.3, 35.4, 35.5, 35.6, 35.7, 35.8, 35.9, 36.0, 36.1, 36.2, 36.3, 36.4, 36.5, 36.6, 36.7, 36.8, 36.9, 37.0, 37.1, 37.2, 37.3, 37.4, 37.5, 37.6, 37.7, 37.8, 37.9, 38.0, 38.1, 38.2, 38.3, 38.4, 38.5, 38.6, 38.7, 38.8, 38.9, 39.0, 39.1, 39.2, 39.3, 39.4, 39.5, 39.6, 39.7, 39.8, 39.9, 40.0, 40.1, 40.2, 40.3, 40.4, 40.5, 40.6, 40.7, 40.8, 40.9, 41.0, 41.1, 41.2, 41.3, 41.4, 41.5, 41.6, 41.7, 41.8, 41.9, 42.0, 42.1, 42.2, 42.3, 42.4, 42.5, 42.6, 42.7, 42.8, 42.9, 43.0, 43.1, 43.2, 43.3, 43.4, 43.5, 43.6, 43.7, 43.8, 43.9, 44.0, 44.1, 44.2, 44.3, 44.4, 44.5, 44.6, 44.7, 44.8, 44.9, 45.0, 45.1, 45.2, 45.3, 45.4, 45.5, 45.6, 45.7, 45.8, 45.9, 46.0, 46.1, 46.2, 46.3, 46.4, 46.5, 46.6, 46.7, 46.8, 46.9, 47.0, 47.1, 47.2, 47.3, 47.4, 47.5, 47.6, 47.7, 47.8, 47.9, 48.0, 48.1, 48.2, 48.3, 48.4, 48.5, 48.6, 48.7, 48.8, 48.9, 49.0, 49.1, 49.2, 49.3, 49.4, 49.5, 49.6, 49.7, 49.8, 49.9, 50.0, 50.1, 50.2, 50.3, 50.4, 50.5, 50.6, 50.7, 50.8, 50.9, 51.0, 51.1, 51.2, 51.3, 51.4, 51.5, 51.6, 51.7, 51.8, 51.9, 52.0, 52.1, 52.2, 52.3, 52.4, 52.5, 52.6, 52.7, 52.8, 52.9, 53.0, 53.1, 53.2, 53.3, 53.4, 53.5, 53.6, 53.7, 53.8, 53.9, 54.0, 54.1, 54.2, 54.3, 54.4, 54.5, 54.6, 54.7, 54.8, 54.9, 55.0, 55.1, 55.2, 55.3, 55.4, 55.5, 55.6, 55.7, 55.8, 55.9, 56.0, 56.1, 56.2, 56.3, 56.4, 56.5, 56.6, 56.7, 56.8, 56.9, 57.0, 57.1, 57.2, 57.3, 57.4, 57.5, 57.6, 57.7, 57.8, 57.9, 58.0, 58.1, 58.2, 58.3, 58.4, 58.5, 58.6, 58.7, 58.8, 58.9, 59.0, 59.1, 59.2, 59.3, 59.4, 59.5, 59.6, 59.7, 59.8, 59.9, 60.0, 60.1, 60.2, 60.3, 60.4, 60.5, 60.6, 60.7, 60.8, 60.9, 61.0, 61.1, 61.2, 61.3, 61.4, 61.5, 61.6, 61.7, 61.8, 61.9, 62.0, 62.1, 62.2, 62.3, 62.4, 62.5, 62.6, 62.7, 62.8, 62.9, 63.0, 63.1, 63.2, 63.3, 63.4, 63.5, 63.6, 63.7, 63.8, 63.9, 64.0, 64.1, 64.2, 64.3, 64.4, 64.5, 64.6, 64.7, 64.8, 64.9, 65.0, 65.1, 65.2, 65.3, 65.4, 65.5, 65.6, 65.7, 65.8, 65.9, 66.0, 66.1, 66.2, 66.3, 66.4, 66.5, 66.6, 66.7, 66.8, 66.9, 67.0, 67.1, 67.2, 67.3, 67.4, 67.5, 67.6, 67.7, 67.8, 67.9, 68.0, 68.1, 68.2, 68.3, 68.4, 68.5, 68.6, 68.7, 68.8, 68.9, 69.0, 69.1, 69.2, 69.3, 69.4, 69.5, 69.6, 69.7, 69.8, 69.9, 70.0, 70.1, 70.2, 70.3, 70.4, 70.5, 70.6, 70.7, 70.8, 70.9, 71.0, 71.1, 71.2, 71.3, 71.4, 71.5, 71.6, 71.7, 71.8, 71.9, 72.0, 72.1, 72.2, 72.3, 72.4, 72.5, 72.6, 72.7, 72.8, 72.9, 73.0, 73.1, 73.2, 73.3, 73.4, 73.5, 73.6, 73.7, 73.8, 73.9, 74.0, 74.1, 74.2, 74.3, 74.4, 74.5, 74.6, 74.7, 74.8, 74.9, 75.0, 75.1, 75.2, 75.3, 75.4, 75.5, 75.6, 75.7, 75.8, 75.9, 76.0, 76.1, 76.2, 76.3, 76.4, 76.5, 76.6, 76.7, 76.8, 76.9, 77.0, 77.1, 77.2, 77.3, 77.4, 77.5, 77.6, 77.7, 77.8, 77.9, 78.0, 78.1, 78.2, 78.3, 78.4, 78.5, 78.6, 78.7, 78.8, 78.9, 79.0, 79.1, 79.2, 79.3, 79.4, 79.5, 79.6, 79.7, 79.8, 79.9, 80.0, 80.1, 80.2, 80.3, 80.4, 80.5, 80.6, 80.7, 80.8, 80.9, 81.0, 81.1, 81.2, 81.3, 81.4, 81.5, 81.6, 81.7, 81.8, 81.9, 82.0, 82.1, 82.2, 82.3, 82.4, 82.5, 82.6, 82.7, 82.8, 82.9, 83.0, 83.1, 83.2, 83.3, 83.4, 83.5, 83.6, 83.7, 83.8, 83.9, 84.0, 84.1, 84.2, 84.3, 84.4, 84.5, 84.6, 84.7, 84.8, 84.9, 85.0, 85.1, 85.2, 85.3, 85.4, 85.5, 85.6, 85.7, 85.8, 85.9, 86.0, 86.1, 86.2, 86.3, 86.4, 86.5, 86.6, 86.7, 86.8, 86.9, 87.0, 87.1, 87.2, 87.3, 87.4, 87.5, 87.6, 87.7, 87.8, 87.9, 88.0, 88.1, 88.2, 88.3, 88.4, 88.5, 88.6, 88.7, 88.8, 88.9, 89.0, 89.1, 89.2, 89.3, 89.4, 89.5, 89.6, 89.7, 89.8, 89.9, 90.0, 90.1, 90.2, 90.3, 90.4, 90.5, 90.6, 90.7, 90.8, 90.9, 91.0, 91.1, 91.2, 91.3, 91.4, 91.5, 91.6, 91.7, 91.8, 91.9, 92.0, 92.1, 92.2, 92.3, 92.4, 92.5, 92.6, 92.7, 92.8, 92.9, 93.0, 93.1, 93.2, 93.3, 93.4, 93.5, 93.6, 93.7, 93.8, 93.9, 94.0, 94.1, 94.2, 94.3, 94.4, 94.5, 94.6, 94.7, 94.8, 94.9, 95.0, 95.1, 95.2, 95.3, 95.4, 95.5, 95.6, 95.7, 95.8, 95.9, 96.0, 96.1, 96.2, 96.3, 96.4, 96.5, 96.6, 96.7, 96.8, 96.9, 97.0, 97.1, 97.2, 97.3, 97.4, 97.5, 97.6, 97.7, 97.8, 97.9, 98.0, 98.1, 98.2, 98.3, 98.4, 98.5, 98.6, 98.7, 98.8, 98.9, 99.0, 99.1, 99.2, 99.3, 99.4, 99.5, 99.6, 99.7, 99.8, 99.9, 100.0</small> (S.S.R. I No. 39.68 P. No. 188) RATE ANALYSIS	46.080	3467.00	Sq.M.	159759.00
20	Providing and fixing corrugated galvanised iron sheets of 0.65mm thick (24 B.W.G.) for roofing without wind tiles including fastening with galvanised iron screws and bolts, lead (S.S.R. I No. 36.05 P. No. 171) RATE ANALYSIS	1733.132	1139.00	Sq.M.	1974037.00
21	Providing and fabricating structural steel work in rolled sections like joists, channels, angles, tees etc. as per detailed design and drawings or as directed including cutting,				

ABSTRACT

SIR. No.	DESCRIPTION OF ITEM	QUANTITY	RATE	UNIT	TOTAL AMOUNT
22	(S. R. I. No. 13.02 P. No. 179) RATE ANALYSIS Providing and fixing rolling shutter fabricated from steel lattice of minimum thickness 0.3mm with lock plate of 3.15mm thickness reinforced with 15x15x5 mm angle section fitted with (S. R. I. No. 19.25 P. No. 164) RATE ANALYSIS	26.309	97759.00	MT	2571942.00
		56.940	5308.00	Sq. M.	302238.00
			TOTAL Rs.		7279579
23	Royalty a) Royalty Charges for sand b) Royalty Charges for other minerals	46.198 382.181	237.37 216.18	cum cum	10966.02 82619.89
			TOTAL ROYALTY Rs.		93585.91
24	Laboratory test of construction material 1) BASIC TEST OF AGGREGATE a) Water Absorption, Specific Gravity Impact Value, Crushing Value b) Sieve Analysis c) Abrasion value d) Flakiness Index & Elongation Index 2) BRICKS Water Absorption (Set of 3 Bricks), Compressive Strength (Set of 3 Bricks), Efflorescence (Set of 3 Bricks). 3) CONCRETE a) Compressive Strength OF C. C. Cubic (Set of 3 cubes) b) Concrete Mix Design (With all Tests on basic materials) 4) STEEL Steel bar testing upto 16 mm (Set of 3 bars) (Tensile strength, % Elongation, Yield Stress, Weight per Meter, Bend / Rebarnd Test, Proof Stress.)	1.00 1.00 1.00 1.00 1.000 1.000 1.000 1.000 1.000	2600.00 690.00 1170.00 850.00 2175.00 690.00 13755.00 1275.00	Nos. Nos. Nos. Nos. Nos. Nos. Nos. Nos. Nos.	2600.00 690.00 1170.00 850.00 2175.00 690.00 13755.00 1275.00
			TOTAL Rs.		23205.00

S. S. Pangave

S. S. Pangave
(B.E. Civil)
Consulting Civil Engineer
T. P. Latur / 643 / 2019
Mob. 8552085000

PROPOSED CONSTRUCTION OF INDUSTRIAL SHED IN GUT NO. 131, AT HASEGAON, TO, AUSA, DIST. LATUR

RATE ANALYSIS AS PER SSR 2022-23

Sr. NO.	DESCRIPTION OF ITEM	QTY.	NET LEAD CHARGES	RATE
1	Excavation for foundation in earth, soil of all types, sand, gravel and soft murum, including removing the excavated material up to a distance of 50 m. beyond the (S.S.R. OF 2022-23 No. 21.02, P.No. 115)			207.00
	TOTAL RATE Rs.			207.00
2	Excavation for foundation in hard murum including removing the excavated material upto distance of 50 metres beyond the building area and stacking and (S.S.R. 1.No. 21.06 P.No. 115)			227.00
	TOTAL RATE Rs.			227.00
3	Providing and laying Cast in situ/Ready Mix cement concrete in M-10 of trap/ granite/ quartzite/ gneiss metal for foundation and bedding including hauling out (S.S.R. 1 No. 24.01 P.No. 131			5830.00
	ADD LEAD CHARGES FOR CEMENT	0.22000	562.95	123.85
	ADD LEAD CHARGES FOR SAND	0.47000	1548.17	727.64
	ADD LEAD CHARGES FOR CR METAL	0.29000	410.55	98.53
	ADD LEAD CHARGES FOR 40MM METAL CB	0.70000	793.44	275.41
	@ADD DIFF COST FOR SAND	0.47000	825.00	387.75
	@ADD DIFF COST FOR 20MM METAL	0.24000	174.00	41.76
	@ADD DIFF COST FOR 40MM METAL CB	0.70000	141.00	98.70
	TOTAL RATE Rs.			7386.24
4	Providing and laying in situ/ready mix cement concrete M-20 of trap/ granite/quartzite/gneiss metal for R.C.C work in foundations like raft, strip foundations, grillage and footings of R.C.C. columns and slab (S.S.R. 1 No. 25.11, P.No. 133)			7104.00
	ADD LEAD CHARGES FOR CEMENT	0.35000	562.95	197.03
	ADD LEAD CHARGES FOR SAND	0.44000	1548.17	681.19
	ADD LEAD CHARGES FOR CR METAL	0.31000	410.55	135.48
	ADD LEAD CHARGES FOR 40MM METAL CB	0.44000	825.00	363.00
	@ADD DIFF COST FOR SAND	0.22000	174.00	38.28
	@ADD DIFF COST FOR 20MM METAL	0.11000	174.00	19.14
	@ADD DIFF COST FOR 40MM METAL CB	0.56000	141.00	-78.96
	TOTAL RATE Rs.			8459.16
5	Providing and laying Cast in situ /Ready Mix cement concrete M20 of trap /granite/quartzite/gneiss metal for R.C.C columns as per detailed designs and drawing or as directed including centering, formwork, cover blocks (S.S.R. 1 No. 25.31, P.No. 134)			13783.00
	ADD LEAD CHARGES FOR CEMENT	0.30000	562.95	168.89
	ADD LEAD CHARGES FOR SAND	0.44000	1548.17	681.19
	ADD LEAD CHARGES FOR CR METAL	0.30000	410.55	135.48
	@ADD DIFF COST FOR SAND	0.44000	825.00	363.00
	@ADD DIFF COST FOR 20MM METAL	0.22000	174.00	38.28
	@ADD DIFF COST FOR 12MM METAL	0.11000	174.00	19.14
	TOTAL RATE Rs.			15188.98
6	Providing and laying Cast in situ /Ready Mix cement concrete M20 of trap/granite/quartzite/gneiss metal for R.C.C. beams and lintels as per detailed designs and (S.S.R. 1.No. 25.50, P.No. 135)			12269.00
	ADD LEAD CHARGES FOR CEMENT	0.35000	562.95	197.03
	ADD LEAD CHARGES FOR SAND	0.42500	1548.17	657.97

RATE ANALYSIS AS PER SSR 2022-23

Sr. No.	DESCRIPTION OF ITEM	QTY.	NET LEAD CHARGES	RATE	
7	ADD LEAD CHARGES FOR CR METAL	0.85000	410.55	348.97	
	@ADD DIFF COST FOR SAND	0.42500	825.00	350.63	
	@ADD DIFF COST FOR 20MM METAL	0.57000	174.00	99.18	
	@ADD DIFF COST FOR 12MM METAL	0.28000	174.00	48.72	
	TOTAL RATE Rs.			13971.50 PerCu.M.	
8	Providing and laying Cast in situ/Ready Mix cement concrete M-20 of trap/granite/ quartzite/gneiss metal for R.C.C. PARDI as per detailed design and drawings (S.S.R.I.No.26.17, P.No.137)			15567.00	
	ADD LEAD CHARGES FOR CEMENT	0.35000	562.95	197.03	
	ADD LEAD CHARGES FOR SAND	0.42500	1548.17	657.97	
	ADD LEAD CHARGES FOR CR METAL	0.85000	410.55	348.97	
	@ADD DIFF COST FOR SAND	0.42500	825.00	350.63	
	@ADD DIFF COST FOR 20MM METAL	0.57000	174.00	99.18	
	@ADD DIFF COST FOR 12MM METAL	0.28000	174.00	48.72	
	TOTAL RATE Rs.			17269.50 PerCu.M.	
	9	Providing and laying Cast in situ /Ready Mix cement concrete M-20 of trap/granite/ quartzite/gneiss metal for R.C.C. slab sand landings as per detailed designs and drawings including centering, formwork, cover blocks, (S.S.R.I.No.25.70, P.No.135)			13932.00
		ADD LEAD CHARGES FOR CEMENT	0.35000	562.95	197.03
ADD LEAD CHARGES FOR SAND		0.42500	1548.17	657.97	
ADD LEAD CHARGES FOR CR METAL		0.85000	410.55	348.97	
@ADD DIFF COST FOR SAND		0.42500	825.00	350.63	
@ADD DIFF COST FOR 20MM METAL		0.57000	174.00	99.18	
@ADD DIFF COST FOR 12MM METAL		0.28000	174.00	48.72	
TOTAL RATE Rs.				15634.50 PerCu.M.	
10		Providing and fixing in position TMT-RE-500 bar reinforcement of various diameters for R.C.C. pile caps, footings, foundations, slabs, beams, columns, canopies, staircase, newels, chajjas, lintels, parris, copings, (S.S.R.I.No.26.05, P.No.137)			13932.00
		ADD LEAD CHARGES FOR CEMENT	0.35000	562.95	197.03
	ADD LEAD CHARGES FOR SAND	0.42500	1548.17	657.97	
	ADD LEAD CHARGES FOR CR METAL	0.85000	410.55	348.97	
	@ADD DIFF COST FOR SAND	0.42500	825.00	350.63	
	@ADD DIFF COST FOR 20MM METAL	0.57000	174.00	99.18	
	@ADD DIFF COST FOR 12MM METAL	0.28000	174.00	48.72	
	TOTAL RATE Rs.			15634.50 PerCu.M.	
	11	Providing and fixing in position TMT-RE-500 bar reinforcement of various diameters for R.C.C. pile caps, footings, foundations, slabs, beams, columns, canopies, staircase, newels, chajjas, lintels, parris, copings, (S.S.R.I.No.26.33, P.No.139)			89703.00
		ADD LEAD CHARGES FOR STEEL	1.00000	348.11	348.11
TOTAL RATE Rs.				90051.11 PerM.T.	
12	Providing soiling using 80mm. size trap metal in 15cm. layer including filling voids with crushed sand/grit, ramming, watering etc. complete. Spec. no. As directed (S.S.R.I.No.21.40 P.No.118)			1454.00	
	ADD LEAD CHARGES FOR METAL	1.00000	410.55	410.55	
	TOTAL RATE Rs.			1864.55 PerCu.M.	
12	Filling in plinth and floors with contractors material/ brought from out side and approved by Engineer incharge in layers of 15 cm to 20 cm including watering (S.S.R.I.No.21.37, P.No.117)			599.00	

RATE ANALYSIS AS PER SSR 2022-23

Sr. No.	Description of Item	Qty.	Net Lead Charges	Rate
	ADD LEAD CHARGES FOR MURUM HARD	1.00000	393.44	393.44
	ADD DIFF COST FOR MURUM HARD	1.00000	37.00	37.00
	TOTAL RATE Rs.			1029.44 PerCu.M.
13	Providing masonry with conventional / Indian Standard type bricks in cement mortar 1:6 in foundation and plinth of inner walls / in plinth of external walls including building out metal manually, striking joints as unseasoned (S.S.R.1 No. 27.01, P.No.144)			7755.00
	ADD LEAD CHARGES FOR CEMENT	0.35000	562.95	197.03
	ADD LEAD CHARGES FOR SAND	0.47500	1548.17	657.97
	ADD LEAD CHARGES FOR BRICKS	0.47500	1121.12	532.53
	@ADD DIFF COST FOR SAND	0.12000	825.00	264.00
	ADD DIFF COST FOR BRICKS	475.000	0.50	237.50
	TOTAL RATE Rs.			9644.04 PerCu.M.
14	Providing masonry with conventional / Indian Standard type bricks in cement mortar 1:6 in superstructure including striking joints, raking out joints, walling and scaffolding complete. (Spec.No.64 G.5 page No.315) (S.S.R.1 No. 27.05, P.No.144)			7995.00
	ADD LEAD CHARGES FOR CEMENT	0.35000	562.95	197.03
	ADD LEAD CHARGES FOR SAND	0.47500	1548.17	657.97
	ADD LEAD CHARGES FOR BRICKS	0.47500	1121.12	532.53
	@ADD DIFF COST FOR SAND	0.12000	825.00	264.00
	ADD DIFF COST FOR BRICKS	475.000	0.50	237.50
	TOTAL RATE Rs.			9884.03 PerCu.M.
15	Providing internal cement plaster 6 mm thick in a single coat in cement mortar 1:4 without neeru finish to concrete surface in all positions including scaffolding and (S.S.R.1 No. 32.01, P.No. 153)			203.00
	ADD LEAD CHARGES FOR CEMENT	0.01000	562.95	5.63
	ADD LEAD CHARGES FOR SAND	0.02000	1548.17	30.96
	@ADD DIFF COST FOR SAND	0.02000	825.00	16.50
	TOTAL RATE Rs.			256.09 PerSq.M.
16	Providing internal cement plaster 20 mm thick in single coat in cement mortar 1:5 without neeru finish to concrete or brick surfaces, in all positions including scaffolding and (S.S.R.1 No. 32.03 P.No. 153)			375.00
	ADD LEAD CHARGES FOR CEMENT	0.01000	562.95	5.63
	ADD LEAD CHARGES FOR SAND	0.02000	1548.17	30.96
	@ADD DIFF COST FOR SAND	0.02000	825.00	16.50
	TOTAL RATE Rs.			428.09 PerSq.M.
17	Providing sand faced plaster externally in cement mortar using approved screened sand, in all positions including base coat of 15 mm thick in cement mortar 1:4 using (S.S.R.1 No. 32.11 P. 153)			639.00
	ADD LEAD CHARGES FOR CEMENT	0.01000	562.95	5.63
	ADD LEAD CHARGES FOR SAND	0.02000	1548.17	30.96
	@ADD DIFF COST FOR SAND	0.02000	825.00	16.50
	TOTAL RATE Rs.			692.09 PerSq.M.
18	Providing and laying in situ cement concrete M20 with tremix treatment for 100 mm thickness for flooring with groove cutting of 4mm wide and 20mm deep with (S.S.R.1 No. 32.11 P. 153)			639.00
	ADD LEAD CHARGES FOR CEMENT	0.01000	562.95	5.63
	ADD LEAD CHARGES FOR SAND	0.02000	1548.17	30.96
	@ADD DIFF COST FOR SAND	0.02000	825.00	16.50
	TOTAL RATE Rs.			692.09 PerSq.M.

RATE ANALYSIS AS PER SSR 2022-23

Sr. No.	DESCRIPTION OF ITEM	QTY.	NET LEAD CHARGES	RATE
	(S.S.R. I No. 11.10 P. 158)			796.00
	ADD LEAD CHARGES FOR CEMENT	0.01000	562.95	5.63
	ADD LEAD CHARGES FOR SAND	0.07000	1548.17	30.96
	ADD LEAD CHARGES FOR CR METAL	0.07000	410.55	8.21
	@ADD DIFF COST FOR SAND	0.07000	825.00	16.50
	@ADD DIFF COST FOR CR METAL	0.07000	174.00	3.48
				860.78 Per Sq.M.
19	Providing and fixing in position powder coated aluminium louvered windows / ventilator of various sizes with powder coating as per detailed drawing and (S.S.R. I No. 39.68 P. No. 188)			
				TOTAL RATE Rs. 3467.00
20	Providing and fixing corrugated galvanized iron sheets of 0.6mm thick (24 B.W.G.) for roofing without wind tiles including fastening with galvanized iron screws and (S.S.R. I No. 38.05 P. No. 171)			
				TOTAL RATE Rs. 1139.00
21	Providing and fabricating structural steel work in rolled sections like joists, channels, angles, tees etc. as per detailed design and drawings or as directed including (S.S.R. I No. 23.02 P. No. 129)			
				TOTAL RATE Rs. 97759.00
22	Providing and fixing rolling shutter fabricated from steel laths of minimum thickness 0.9mm with lock plate of 3.15mm thickness reinforced with 35x35x5 mm angle (S.S.R. I No. 38.05 P. No. 171)			
				TOTAL RATE Rs. 5308.00
				5308.00
				SQM

PROPOSED CONSTRUCTION OF INDUSTRIAL SHED IN GUT NO. 131, AT HASEGAON, TQ. AUSA, DIST. LATUR

DIFF. COST OF MATERIAL

SER NO	MATERIAL	RATE AS PER SIR OF 2022	MARKET RATE	EXCESS	LESS	REMARKS/ EFFECTIVE DATE
1	SAND	1175.00	2405.00	1230.00	0.00	Rate As On
2	JOINT METAL	336.00	1175.00	839.00	0.00	Rate As On
3	1.2MM METAL	336.00	1175.00	839.00	0.00	Rate As On
4	40MM METAL CB	321.00	250.00	0.00	141.00	Rate As On
5	BRICKS	4.00	5.50	0.50	0.00	Rate As On
6	MEURUM HARD	258.00	275.00	17.00	0.00	Rate As On

PROPOSED CONSTRUCTION OF INDUSTRIAL SHED IN GUT NO. 131, AT HASEGAON, TC, AUSA, DIST. LATUR

LEAD CHART (AS PER S.R. 2022-23)

SIR. NO.	MATERIAL	TYPE OF MATERIAL	LOCATION OF QUARRY	LEAD IN KM.	LEAD CHARGES	INITIAL LEAD CHARGES	NET LEAD CHARGES.
1	CEMENT	MANUAL	LATUR	20.00	162.35	0.00	162.35
2	SAND	MACHINE	GANGAHED	100.00	1548.17	0.00	1548.17
3	CB METAL	MACHINE	SAROLA	15.00	410.55	0.00	410.55
4	40MM METAL CB	MACHINE	SAROLA	15.00	393.44	0.00	393.44
5	STEEL	MANUAL	LATUR	20.00	548.11	0.00	548.11
6	BRICKS	MANUAL	LATUR	20.00	1121.12	0.00	1121.12
7	MURUM HARD	MACHINE	LOCAL	15.00	303.44	0.00	303.44
8	GRANITE	MANUAL	LATUR	20.00	34.81	0.00	34.81